

PICA

GENERAL LUMINAIRE



EASY
LED



**EASY LED PICA IS A STURDY AND EFFICIENT
GENERAL LUMINAIRE FOR WAREHOUSES,
INDUSTRIAL HALLS AND LOGISTICS CENTERS.
ALSO IP65 VERSION AVAILABLE FOR THE
FOOD INDUSTRY INTERIOR LIGHTING.**

PLEASANT WORK LIGHTING

PICA's low flicker index ensures excellent lighting for all working conditions.

FLICKER FREE ADJUSTMENT

PICA's high-quality dimming technology ensures flicker-free light level adjustments.

EASY TO INSTALL

PICA is delivered fully assembled. Surface mounting with screws directly on the ceiling or rail. Versatile optional spring clips available

The luminaire is designed to be maintenance-free.

LIGHT DISTRIBUTION

Extra wide

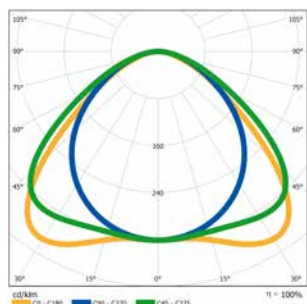

Medium Wide

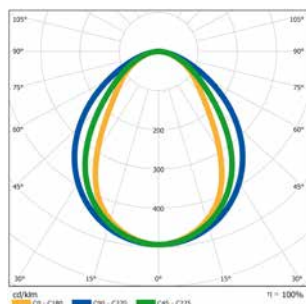

Wide

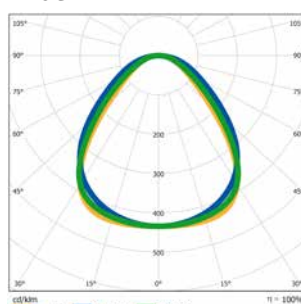

Oval

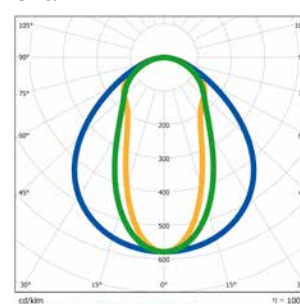

PICA TECHNICAL INFORMATION

| | | | | | |
|--|---|--------------------|----------------------|-------------------------|---------------------------|
| Dimensions (LxWxH) | 1180 x 105 x 66mm | | | | |
| Weight | 2.9 - 4,1 kg (depending on the model) | | | | |
| Housing | White painted aluminium profile (RAL9010) and metal ends. | | | | |
| Optics | Tough and stable PMMA plastics. Polycarbonate light cover in the IP65 version. | | | | |
| Flicker Free | Full power: Flicker free. Flicker index <0,01 at <5kHz when dimming. Flicker index <0,02 at <5kHz when <5% dimming level. | | | | |
| Protection rating | IP43 as standard, IP65 version available. | | | | |
| Control | DALI-2 control option available | | | | |
| Connection | | PICA (Dali) | PICA (on-off) | PICA IP65 (Dali) | PICA IP65 (on-off) |
| Preinstalled cable | | x | x | x | x |
| Available: | | | | | |
| Preinstalled cable with schuko plug | | | x | | x |
| Quick connector | | x | x | x | x |
| Series installation (quick connectors) | | x | | x | |
| 3-phase series installation (quick connectors) | | | x | | x |
| | (Quick connector ambient temperature maximum +40°C) | | | | |
| Temperature range | Designed for ambient temperatures of -25°C ...+55°C (non-condensing), depending on the model | | | | |
| Light colour: | 4000 K | | | | |
| CRI: | >80 Ra | | | | |
| Maintenance free luminaire usage life: | L90 up to 55 000 h L80 up to >100 000 h | | | | |
| Input voltage | 230 VAC (operation range: 198 - 264 VAC, 176 - 280 VDC) | | | | |
| Input frequency | 50/60 Hz | | | | |
| Power Factor (PF) typical | >0,95 (1-25: >0,9) | | | | |
| Surge protection: | 2 kV L-GND / N-GND, 1 kV L-N (IEC 61000-4-5) | | | | |
| Luminaire protection class | CL I | | | | |
| Guarantee | 5 years | | | | |



| PICA | PICA 1 | | | | PICA 2 | | PICA 3 | |
|--------------------------------------|--|---------------------------------|---------------------------------|------------------|--|-------------------|--|----------|
| Light lines | 1 | | | | 2 | | 3 | |
| Weight | 2,9 kg | | | | 3,1 kg | | 3,5 kg | |
| Dali addresses | 1 | | | | 1 | | 2 | |
| Temperature range | 1-25 & 1-40: -25°C ... +55°C | 1-60: -25°C ... +50°C | 1-80: -25°C ... +50°C | | -25°C ... +45°C | -25°C ... +40°C | -25°C ... +35°C | |
| Maintenance free operating life DALI | 1-25 & 1-40: >100kh (+25°C), 100kh (+50°C), 80kh (+55°C) | | | | 2-100: 100kh (+25°C), 30kh (+45°C) | | 3-200: 100kh (+15°C), 60kh (+25°C), 30kh (+35°C) | |
| | 1-60: >100kh (+25°C), 100kh (+35°C), 40kh (+50°C) | | | | 2-150: >100kh (+25°C), 100kh (+30°C), 65kh (+40°C) | | | |
| | 1-80: >100kh (+25°C), 100kh (+35°C), 25kh (+50°C) | | | | | | | |
| Version | PICA 1-25 | PICA 1-40 | PICA 1-60 | PICA 1-80 | PICA 2-100 | PICA 2-150 | PICA 3-200 | |
| System power | 24 W | 41 W | 59 W | 81 W | 105 W | 149 W | 198 W | |
| Current | 0,2 A | 0,2 A | 0,3 A | 0,4 A | 0,5 A | 0,7 A | 0,9 A | |
| Luminous Flux* | 4 300 lm | 7 300 lm | 10 000 lm | 13 300 lm | 19 100 lm | 24 800 lm | 33 700 lm | |
| Lumen maintenance | L90 | 55 000 h | 55 000 h | 50 000 h | 42 000 h | 50 000 h | 40 000 h | 42 000 h |
| | L80 | >100 000 h | >100 000 h | >100 000 h | 95 000 h | >100 000 h | 90 000 h | 95 000 h |

DALI models dimming range

| | | | | | | | |
|---------------------|-----|-----|-----|-----|-----|-----|-----|
| Light minimum level | 2% | 1% | 1% | 1% | 1% | 1% | 1% |
| Power minimum level | 1 W | 1 W | 2 W | 2 W | 2 W | 2 W | 4 W |

Values shown are nominal values and are subject to +/- 10% tolerance. *Luminous flux for 840, dependent on choice of optical solution. For latest values, ask for light distribution files. Note effect of cable current on luminaire maximum ambient temperatures when using models with internal series wiring.

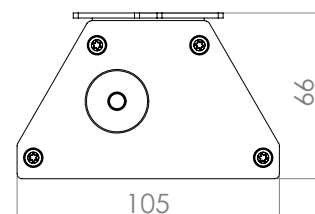
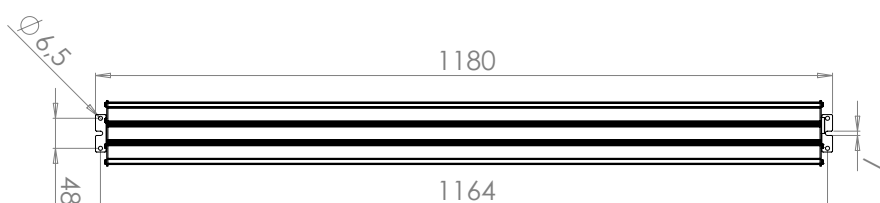



| PICA IP65 | PICA IP65 1 | | | | PICA IP65 2 | | PICA IP65 3 | |
|--------------------------------------|---|-------------------|--------------------------|-------------------|--|--------------------|---|----------|
| Light lines | 1 | | | | 2 | | 3 | |
| Weight | 3,4 kg | | | | 3,6 kg | | 4,1 kg | |
| Dali addresses | 1 | | | | 1 | | 2 | |
| Temperature range | 1-25 & 1-40: -25°C ... +50°C | | 1-60: -25°C ... +50°C | | 1-80: -25°C ... +50°C | | -25°C ... +30°C | |
| Maintenance free operating life DALI | 1-25 & 1-40: >100kh (+25°C), 100kh (+45°C), 80kh (+50°C) | | | | 2-100: 100kh (+25°C), 30kh (+45°C) | | 3-200: 100kh (+10°C), 50kh (+25°C), 35kh (+30°C) | |
| | 1-60: >100kh (+25°C), 100kh (+35°C), 40kh (+50°C) | | | | 2-150: >100kh (+25°C), 100kh (+30°C), 90kh (+35°C) | | | |
| | 1-80: >100kh (+25°C), 100kh (+30°C), 25kh (+50°C) | | | | | | | |
| Version | PICA IP65 1-25 | PICA IP65 1-40 | PICA IP65 1-60 | PICA IP65 1-80 | PICA IP65 2-100 | PICA IP65 2-150 | PICA IP65 3-200 | |
| System power | 24 W | 41 W | 59 W | 81 W | 105 W | 149 W | 198 W | |
| Current | 0,2 A | 0,2 A | 0,3 A | 0,4 A | 0,5 A | 0,7 A | 0,9 A | |
| Luminous Flux* | 3 700 lm | 6 300 lm | 8 800 lm | 11 600 lm | 16 700 lm | 21 800 lm | 29 500 lm | |
| Lumen maintenance | L90 | 55 000 h | 55 000 h | 50 000 h | 40 000 h | 50 000 h | 38 000 h | 40 000 h |
| | L80 | >100 000 h | >100 000 h | >100 000 h | 90 000 h | >100 000 h | 85 000 h | 90 000 h |

DALI models dimming range

| | | | | | | | |
|---------------------|-----|-----|-----|-----|-----|-----|-----|
| Light minimum level | 2 % | 1 % | 1 % | 1 % | 1 % | 1 % | 1 % |
| Power minimum level | 1 W | 1 W | 2 W | 2 W | 2 W | 2 W | 4 W |

Values shown are nominal values and are subject to +/- 10% tolerance. *Luminous flux for 840, dependent on choice of optical solution.

For latest values, ask for light distribution files. Note effect of cable current on luminaire maximum ambient temperatures when using models with internal series wiring.

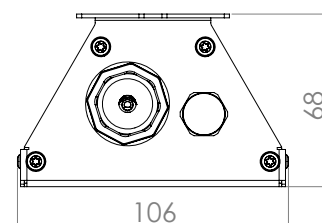
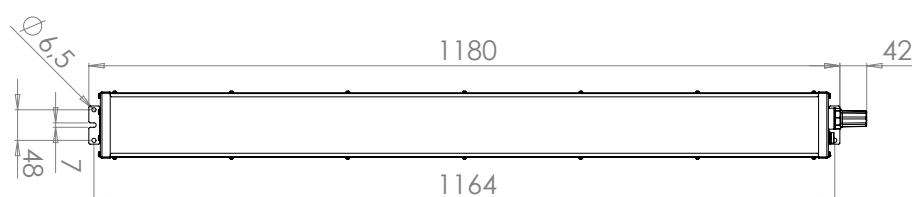



www.easyled.fi

Easy LED Oy
Meriniitynkatu 11
FI-24100 Salo, FINLAND
Tel. +358 2 737 44 20

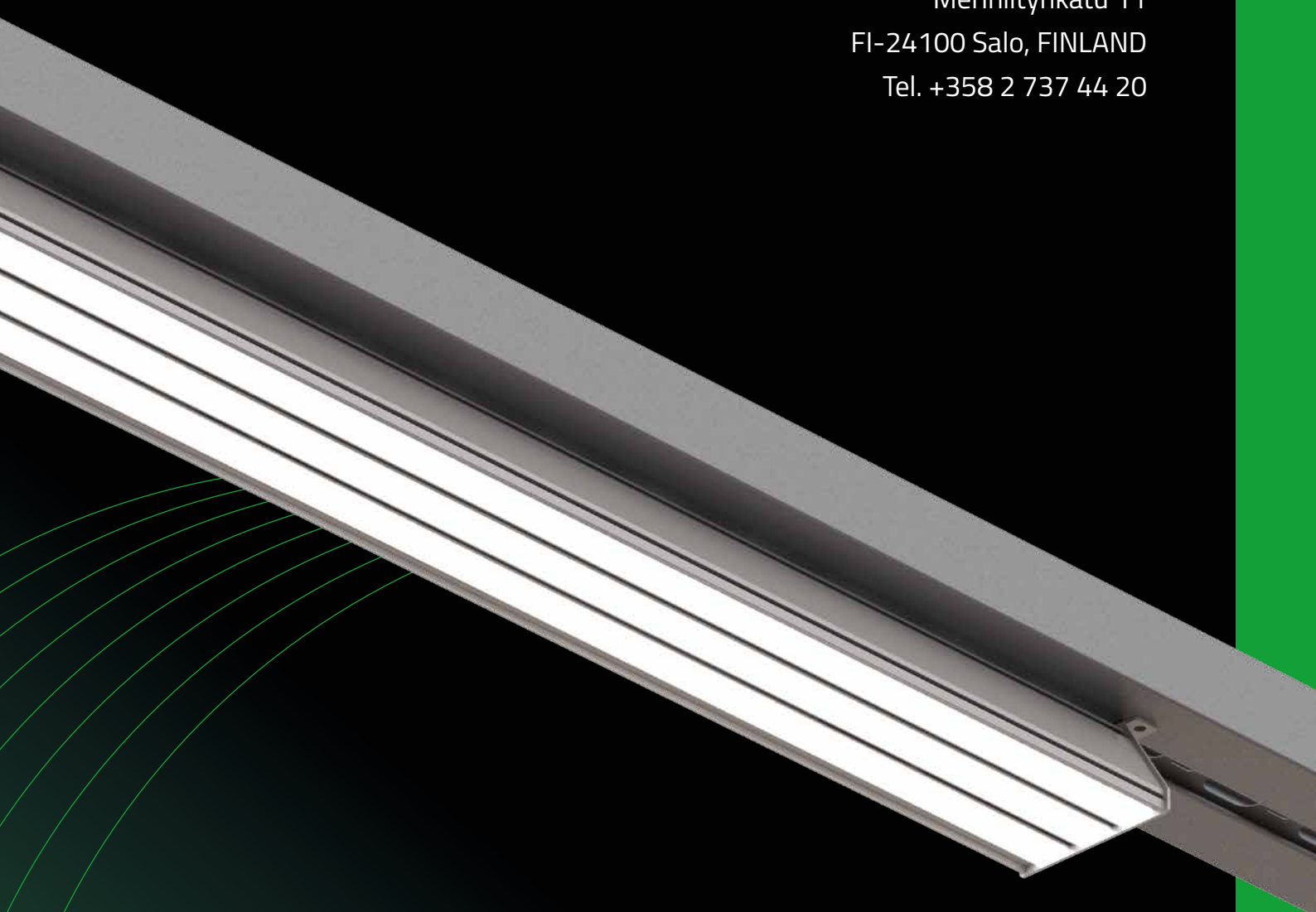

EASY
LED

Investing in high quality LED lighting today will pay off far into the future. Easy LED Oy is a Finnish company specialised in manufacturing of energy efficient LED lighting systems for different environments, such as sports arenas, industrial premises, roads and areas as well as retail and office spaces.