

EASY | LED
www.easyled.fi



MISS NOTHING.

BUBBO[®]

FLOODLIGHT SYSTEM

BUBO®

UP TO 1,5 kW
UP TO 182 000 lm

BUBO® PRODUCT FAMILY

Versions B1, B2 and B3 class LED floodlights

Power up to 1 540 W
Light output up to 182 000 lm
Efficacy up to 154 lm/W

FLOODLIGHT EFFICACY - Bubo B3, B2 or B1

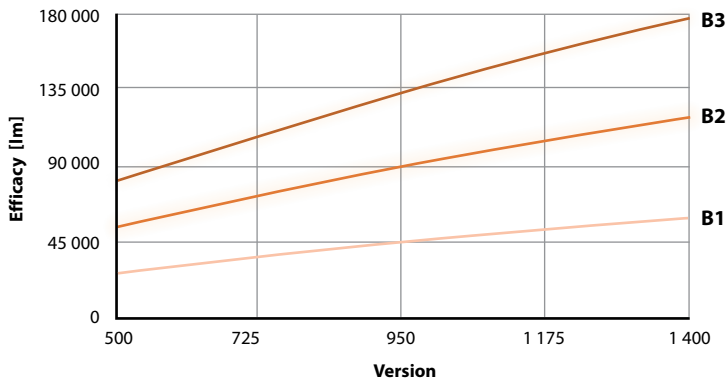

Light Efficacy

The LED technology available in the Bubo™ series meets the strictest TLCI (Television Lighting Consistency Index) requirements for comprehensive high-definition broadcasting with highest quality motion reproduction using flicker-free technology.

The TLCI is similar to the CRI but describes the color rendering for TV cameras.

	CRI >70	CRI >80	CRI >90	
5 700 K		x	o	x = standard o = option
5 000 K	x	o		
4 000 K	x	x		
3 000 K	o			

TLCI

Television Lighting Consistency Index of over 90 available

Flicker Free

Flicker Free dimming down to 140 mA level.
With PWM technology down to 15 mA (400 - 500 Hz).

Materials

Light engine: Die-casted aluminium chassis with shot-blasted, textured body

Gear unit: Die-casted aluminium chassis with surface texturing, die-casted aluminium lids.

Mounting and frame components: Stainless steel, delta treated screws

Glass: Extra clear thermally hardened glass and stainless steel frame

Optics

Standard symmetrical optics with 12, 34, 70 and 110 degree light distribution beam. Flood light optics UP-F.

IP- and IK-classes IP66, IK08

Protection class CL I

Luminaire ambient temperature range Up to -40...+60°C (95% RH)

Control

DALI as standard, optional DMX/RDM and 1-10 V available, also compatible with wide range of intelligent control methods.

Mains voltage

230 VAC (operation voltage range:198-264 VAC)

Frequency 50/60 Hz

Power factor PF > 0,95

Surge protection

Standard 4 kV/6 kV - L-N/L-GND, N-GND

Thermal protection

Standard bi-functional protection with active power adjustment function.

Other

Standard intelligent inrush current control system
Gradual turn-on process in cold environments for protection of LED components.

Installation

Flexible with a range of mounting accessories. Precision aiming device available.

Guarantee 5 years

Additional components / Mounting components

Alternative installation methods for the gear unit
Extension cable kits and long-distance cabling packages available

Surge protection 20kV with two level protection. Protective components designed specially for devices installed in high position.



PRODUCT WEIGHT INFORMATION (KG)

	Rack with light engines		Bracket		Gear unit	
	Stadion	Area	Hall	Unit	Mounting	
Bubo B1	9,4 kg		3 kg			
Bubo B2	22,2 kg	8,8 kg	9 kg	6,3 kg	7,6 kg	0,5 kg
Bubo B3	33,3 kg	8,8 kg	9 kg	6,3 kg	8,7 kg	0,5 kg
Total weight						
Bubo B1G	16 kg					

BUBO® MODELS

Model B1						
Version	500	700	850	1000	1200	1400
LEDs	120					
Input power [W]	180 W	251 W	305 W	360 W	437 W	514 W
Luminous flux [lm]	27 650 lm	36 580 lm	42 510 lm	48 250 lm	55 010 lm	61 040 lm

Model B2						
Version	500	700	850	1000	1200	1400
LEDs	240					
Input power [W]	360 W	502 W	610 W	720 W	874 W	1 027 W
Luminous flux [lm]	55 300 lm	73 150 lm	85 020 lm	96 510 lm	110 020 lm	121 780 lm

Model B3						
Version	500	700	850	1000	1200	1400
LEDs	360					
Input power [W]	540 W	753 W	915 W	1 080 W	1 310 W	1 540 W
Luminous flux [lm]	82 950 lm	109 550 lm	127 320 lm	144 280 lm	164 200 lm	181 900 lm



B1

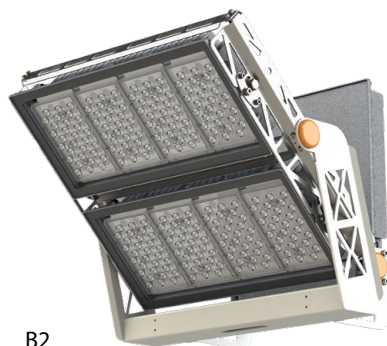

B2

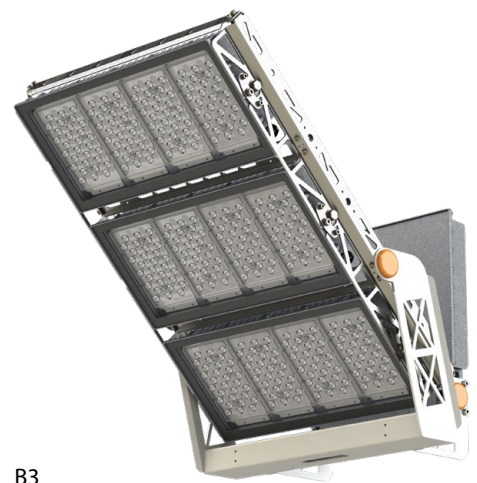

B3

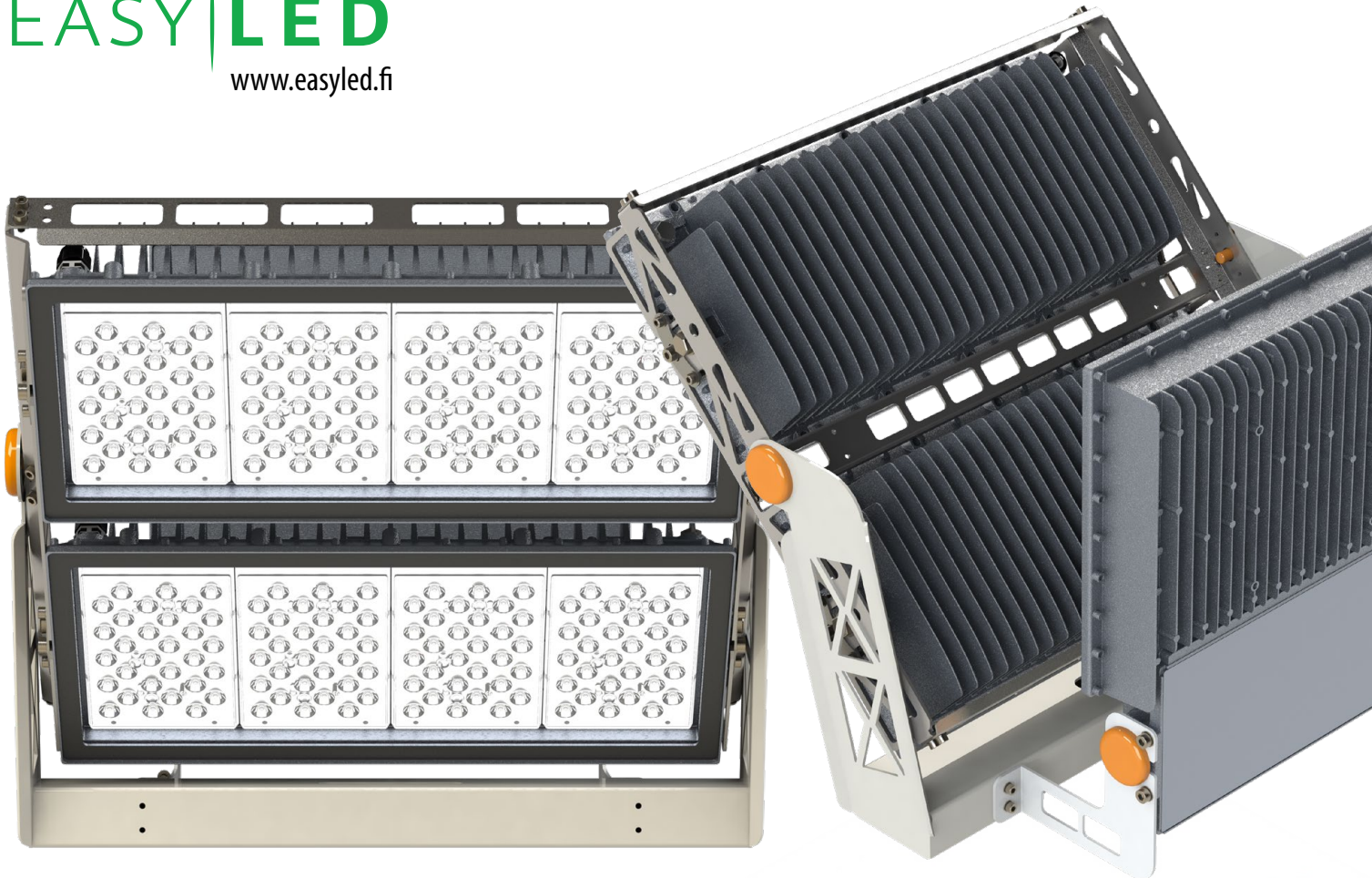

BUBO® | MISS NOTHING.

A perfect scoring position in front of a cheering audience, a demanding cargo loading job for the last boat of the night, or a large warehouse area under your watchful eyes - BUBO® lights up your success. BUBO® lighting system, designed for illuminating large areas, is the perfect choice for stadiums and arenas, ports, storage areas, airports and cranes. Also applicable to indirect lighting. Easy LED's lighting solution and design know-how guarantees you illumination that meets your needs.

BUBO® the biggest and the brightest: The lighting system is designed for large area illumination. The luminaires are available in one, two or three module systems and offer unbeatable light efficacy.

BUBO® is intelligent: Intelligent lighting control methods, DALI-system (standard). DMX/RDM available. Dynamic control and management; instant ON/OFF.

BUBO® is cost-effective: The luminaire is assembled in a tough die-casted aluminium chassis and it requires little maintenance and has a long lifespan of several decades.

BUBO® is TV-compatible: The uniform, flicker-free light is compatible with current broadcasting requirements, which is especially important in sports broadcasting.

BUBO® -LIGHTING SYSTEM LIFESPAN WITH GEAR UNIT (standard)

AREA						
Version	360-500	360-700	360-850	360-1000	360-1200	360-1400
LED Module CRI72 and CRI82 L95 , C10 [h]	>100 000				90 000	50 000
LED Module CRI72 and CRI82 L90 , C10 [h]	>150 000					100 000

BUBO® -LIGHTNING SYSTEM LUMINAIRE AMBIENT TEMPERATURE WITH GEAR UNIT (standard)

Max Temperature outdoors	+60°C	+55°C	+50°C	+50°C	+45°C	+40°C
Max Temperature indoors	+55°C	+50°C	+45°C	+45°C	+35°C	+30°C
Min Temperature	-40°C					
Gear unit lifespan @ta25	>100 000					75 000

BUBO® -LIGHTING SYSTEM LIFESPAN WITH GEAR UNIT (standard)

STADIUM						
Version	360-500	360-700	360-850	360-1000	360-1200	360-1400
LED Module CRI72 and CRI82 L95 , C10 [h]	>100 000				90 000	50 000
LED Module CRI72 and CRI82 L90 , C10 [h]	>150 000					100 000

BUBO® -LIGHTNING SYSTEM LUMINAIRE AMBIENT TEMPERATURE WITH GEAR UNIT (standard)

Max Temperature outdoors	+65°C	+60°C	+60°C	+55°C	+45°C	+35°C*
Max Temperature indoors	+60°C	+55°C	+55°C	+50°C	+40°C	+30°C*
Min Temperature	-40°C					
Gear unit lifespan @ta25	>100 000					

*Bubo is also suitable for indirect lighting. Different maximum operating temperatures for the 1400 mA version: +30°C outside and +25°C inside.

BUBO® DIMENSIONS

Bubo® B1G

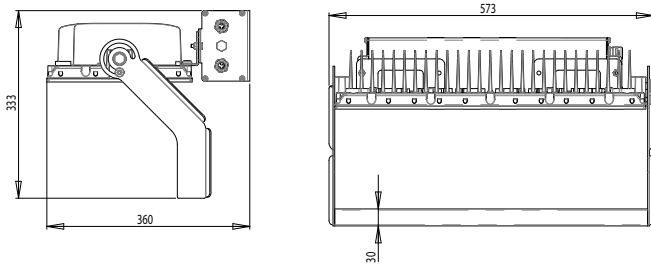

Bubo® B1

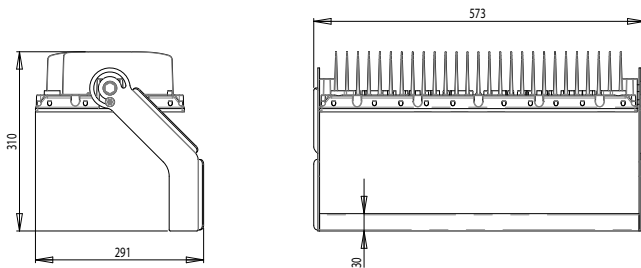

Bubo® B2 area

Bubo® B2 stadium

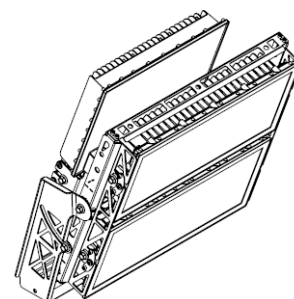
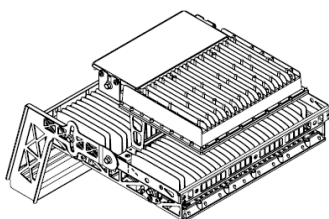
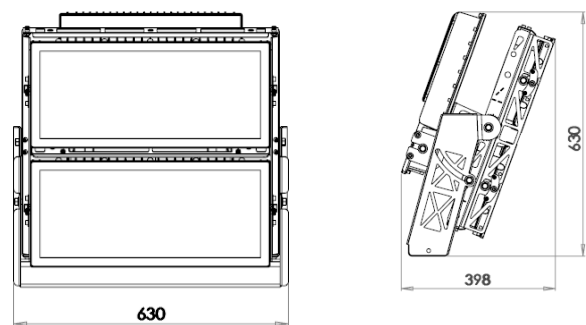
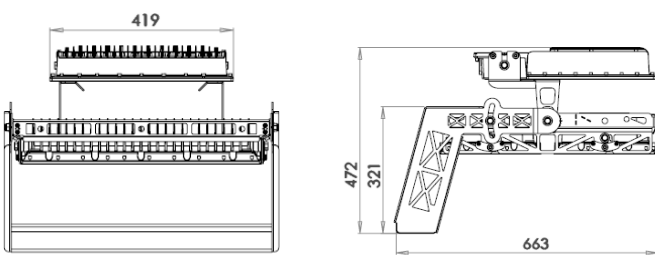

Bubo® B3 area

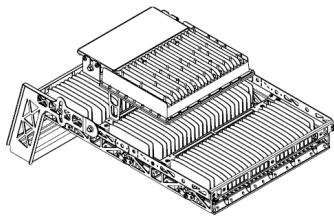
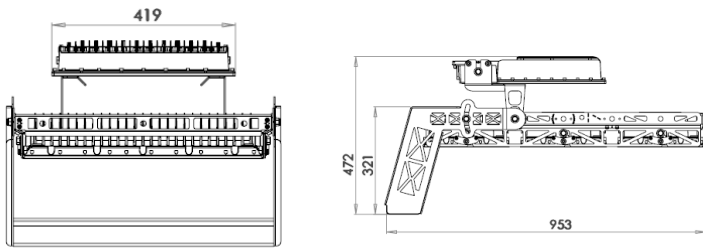

Bubo® B3 stadium

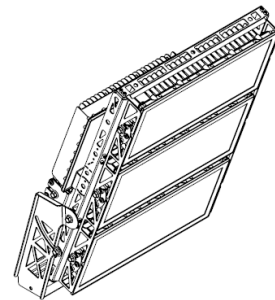
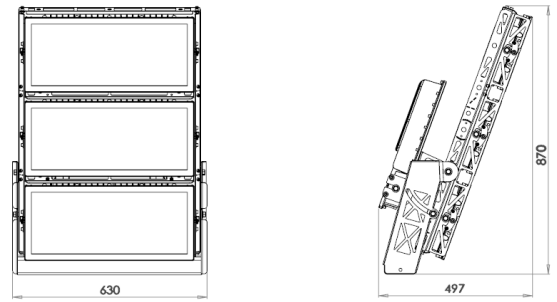

Bubo® brackets

B1G/B1 bracket

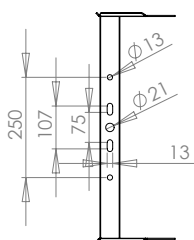
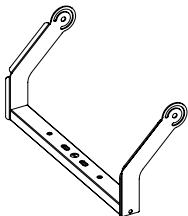
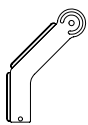

Area bracket

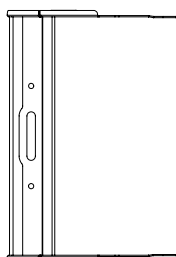
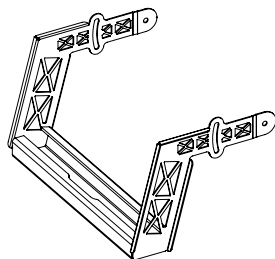
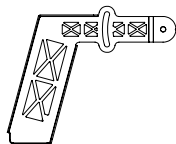

Stadium bracket

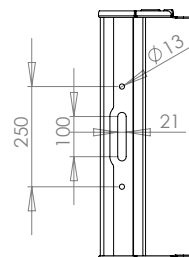
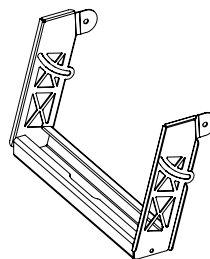
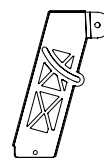

Hall bracket

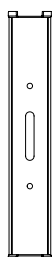
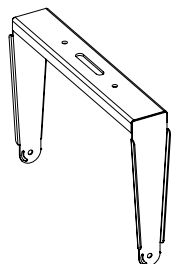



BUBO®

FLOODLIGHT SYSTEM

EASY LED THE BRIGHT CHOICE

Investing in high quality LED lighting today will pay off far into the future. Easy LED Oy is a Finnish company specialised in manufacturing of energy efficient LED lighting systems for different environments, such as sports arenas, industrial premises, roads and areas as well as retail and office spaces.



EASY LED

Easy LED Oy
Meriniitynkatu 11
FI-24100 Salo, FINLAND
tel. +358 2 737 44 20

easyled.fi

